

B1N360V-QR20-IOLX3-H1141

Inclinometer

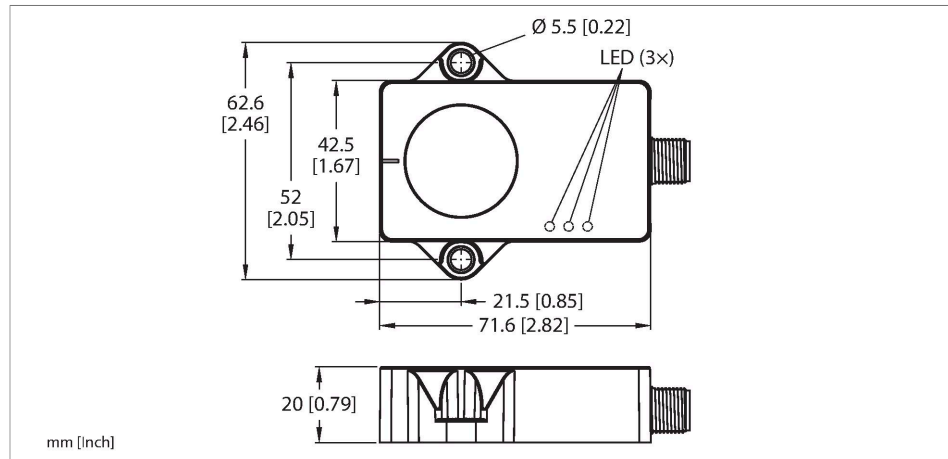

Technical data

Type	B1N360V-QR20-IOLX3-H1141
ID no.	100025084
Measuring principle	Acceleration
Measuring range	0...360 °
Number of measuring axes	1
Repeat accuracy	≤ 0.05 % of full scale
Linearity deviation	≤ 0.2 %
Temperature drift	≤ ± 0.006 % / K
Resolution	≤ 0.01 °
Ambient temperature	-40...+85 °C
Temperature changes (EN60068-2-14)	-40... +85 °C; 20 cycles
Operating voltage	18...30 VDC
Residual ripple	≤ 10 % U _{ss}
Isolation test voltage	≤ 0.5 kV
Wire breakage/Reverse polarity protection	yes
Communication protocol	IO-Link
Current consumption	< 50 mA
Communication mode	COM 3 (230.4 kBaud)
Minimum cycle time	1.3 ms
Function Pin 4	IO-Link
Design	Rectangular, QR20
Dimensions	71.4 x 62.5 x 20 mm
Housing material	Plastic, Ultem
Electrical connection	Connector, M12 × 1

Features

- Rectangular, plastic, Ultem
- Status displayed via LED
- Angle detection via one axis with 360 ° measuring range
- Temperature detection from -40 °C to 85 °C
- High protection class IP68/IP69K
- Protected against salt spray and rapid temperature change
- 18...30 VDC
- M12 × 1 connector, 4-pin
- Communication via IO-Link

Wiring diagram

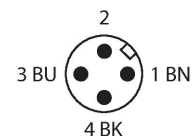
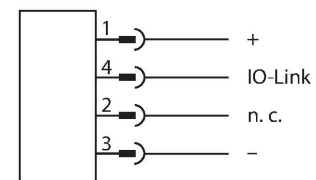

Functional principle

The inclinometers use an acceleration measuring cell to determine the angle. The Earth's gravity is used as a reference. If the inclinometer changes its angle relative to the Earth's gravity, this is detected by the

Technical data

Vibration resistance (EN 60068-2-6)	20 g; 5 h/axis; 3 axes
Shock resistance (EN 60068-2-27)	150 g; 4 ms ½ sine
Protection class	IP68 IP69K
MTTF	548 years acc. to SN 29500 (Ed. 99) 40 °C
Power-on indication	LED, Green
Measuring range display	LED, yellow

acceleration measuring cell. The signal is then linearized so that a value proportional to the angle is output.

The measuring principle used makes mounting and commissioning the device easy. The robust sensors are positioned with the cast side on a flat surface so that the casting compound is covered. The sensor is then secured with two screws.

The sensor can also record the temperature, which can be used to monitor the condition of the machine.

Mounting instructions

Mounting instructions/Description

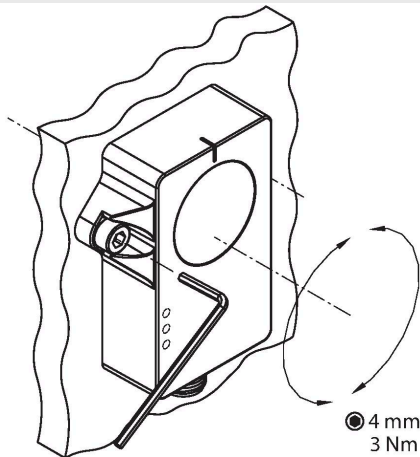

Wiring accessories

Dimension drawing	Type	ID no.	
	RKC4T-2-RSC4T/TXL	6625604	Extension cable, M12 female, straight, 3-pin to M12 male, straight, 3-pin; cable length: 2 m, jacket material: PUR, black; cULus approval; other cable lengths and qualities available, see www.turck.com
	RKC4T-2/TXL	6625500	Connection cable, female M12, straight, 3-pin, cable length: 2 m, sheath material: PUR, black; cULus approval; other cable lengths and qualities available, see www.turck.com